

Coudes

Coude 60 degrés

Resin Type: Derakane 411

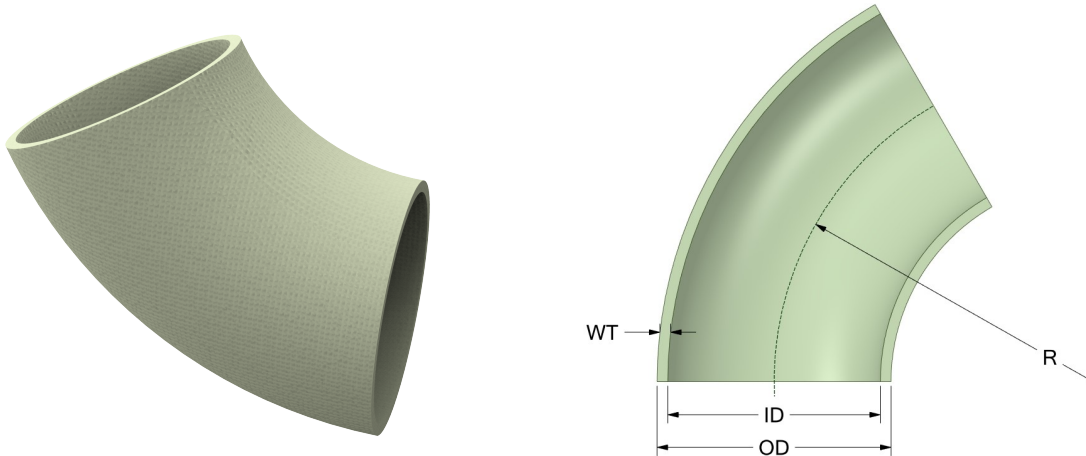

#	DN (mm)	Pmax (bar)	Bend Angle (deg)	ID (mm)	OD (mm)	WT (mm)	R (mm)	Article Number
1	25	16	60	25	33	4.0	75	EMS60-25-16/PE
2	32	16	60	32	42	5.0	96	EMS60-32-16/PE
3	40	16	60	40	50	5.0	120	EMS60-40-16/PE
4	50	16	60	50	60	5.0	140	EMS60-50-16/PE
5	65	16	60	65	77	6.0	95	EMS60-65-16/PE
6	80	16	60	80	92	6.0	120	EMS60-80-16/PE
7	100	16	60	100	112	6.0	150	EMS60-100-16/PE
8	125	16	60	125	139	7.0	190	EMS60-125-16/PE
9	150	16	60	150	166	8.0	225	EMS60-150-16/PE
10	200	10	60	200	216	8.0	300	EMS60-200-10/PE
11	200	16	60	200	222	11.0	300	EMS60-200-16/PE
12	250	10	60	250	266	8.0	375	EMS60-250-10/PE
13	250	16	60	250	274	12.0	375	EMS60-250-16/PE
14	300	10	60	300	318	9.0	450	EMS60-300-10/PE
15	300	16	60	300	326	13.0	450	EMS60-300-16/PE
16	350	10	60	350	370	10.0	525	EMS60-350-10/PE

Disclaimer

Whilst every care is taken to ensure that the information on this website is complete and accurate, the Rotec Composite Group BV cannot accept responsibility for any omissions or inaccuracies or for any consequences arising therefrom. By using this website, the user accepts the terms of this disclaimer.

Coudes

Coude 60 degrés

Resin Type: Derakane 411

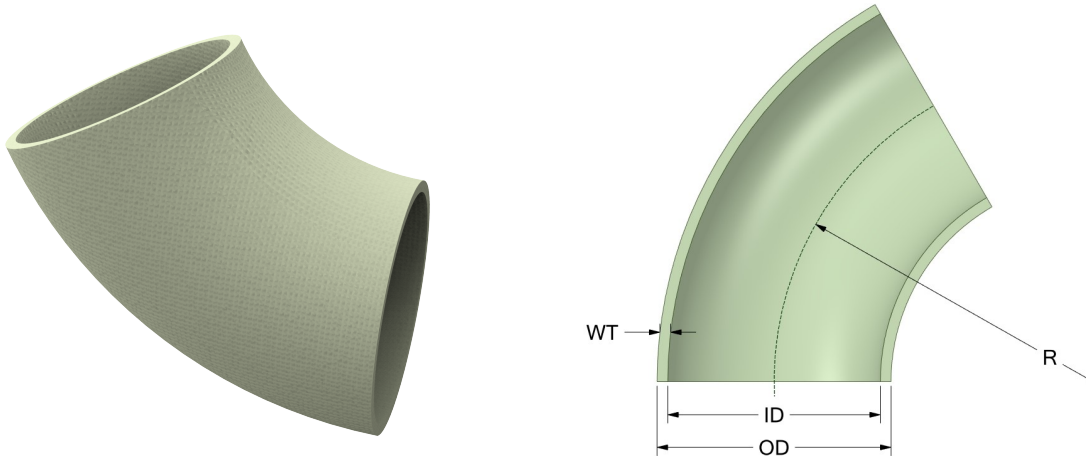

#	DN (mm)	Pmax (bar)	Bend Angle (deg)	ID (mm)	OD (mm)	WT (mm)	R (mm)	Article Number
17	350	16	60	350	365	8.5	525	EMS60-350-16/PE
18	400	10	60	394	408	7.0	600	EMS60-400-10/PE
19	400	16	60	394	412	9.0	600	EMS60-400-16/PE
20	450	10	60	434	450	8.0	675	EMS60-450-10/PE
21	450	16	60	434	455	10.5	675	EMS60-450-16/PE
22	500	10	60	482	502	10.0	750	EMS60-500-10/PE
23	500	16	60	482	508	13.0	750	EMS60-500-16/PE
24	600	10	60	579	603	12.0	900	EMS60-600-10/PE
25	600	16	60	579	609	15.0	900	EMS60-600-16/PE

Disclaimer

Whilst every care is taken to ensure that the information on this website is complete and accurate, the Rotec Composite Group BV cannot accept responsibility for any omissions or inaccuracies or for any consequences arising therefrom. By using this website, the user accepts the terms of this disclaimer.