

# Rotec Brides tubulées

## Bride fixe tubulée

Drilling Standard: EN1092 PN16, Resin Type: Derakane 470

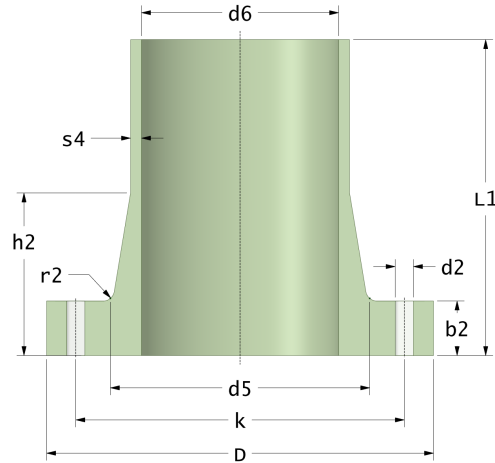

#	DN (mm)	Pmax (bar)	D (mm)	d6 (mm)	d5 (mm)	r2 (mm)	s4 (mm)	k (mm)	Holes (no.)	d2 (mm)	L1 (mm)	h2 (mm)	b2 (mm)	Article Number
1	25	16	116	25	50	1	4	85	4	14	250	30	14	TFC-25-250/16
2	40	16	150	40	68	1	5	110	4	18	300	40	16	TFC-40-300/16
3	50	16	164	50	82	1	5	125	4	18	300	40	18	TFC-50-300/16
4	65	16	184	65	95	1	5	145	4	18	300	50	20	TFC-65-300/16
5	80	16	200	80	111	2	6	160	8	18	300	50	22	TFC-80-300/16
6	100	16	220	100	133	2	6	180	8	18	300	55	25	TFC-100-300/16
7	125	16	254	125	160	2	6	210	8	18	300	65	27	TFC-125-300/16
8	150	16	284	150	188	3	6	240	8	22	300	70	30	TFC-150-300/16

### Disclaimer

Whilst every care is taken to ensure that the information on this website is complete and accurate, the Rotec Composite Group BV cannot accept responsibility for any omissions or inaccuracies or for any consequences arising therefrom. By using this website, the user accepts the terms of this disclaimer.

17-11-2022