

Bögen

Bogen 60 Grad Typ PE

Resin Type: Derakane 470

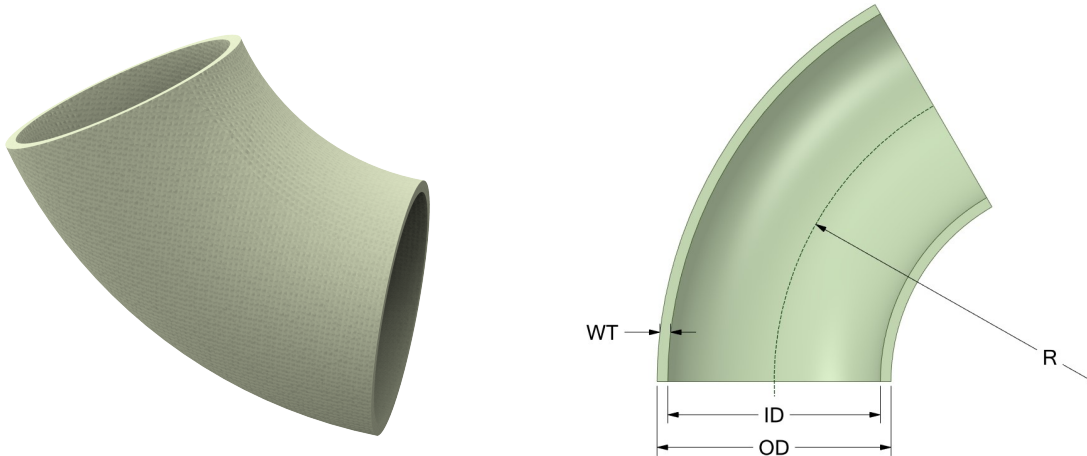

#	DN (mm)	Pmax (bar)	Bend Angle (deg)	ID (mm)	OD (mm)	WT (mm)	R (mm)	Article Number
1	25	16	60	25	33	4.0	75	EMC60-25-16/PE
2	32	16	60	32	42	5.0	96	EMC60-32-16/PE
3	40	16	60	40	50	5.0	120	EMC60-40-16/PE
4	50	16	60	50	60	5.0	140	EMC60-50-16/PE
5	65	16	60	65	77	6.0	95	EMC60-65-16/PE
6	80	16	60	80	92	6.0	120	EMC60-80-16/PE
7	100	16	60	100	112	6.0	150	EMC60-100-16/PE
8	125	16	60	125	139	7.0	190	EMC60-125-16/PE
9	150	16	60	150	166	8.0	225	EMC60-150-16/PE
10	200	10	60	200	216	8.0	300	EMC60-200-10/PE
11	200	16	60	200	222	11.0	300	EMC60-200-16/PE
12	250	10	60	250	266	8.0	375	EMC60-250-10/PE
13	250	16	60	250	274	12.0	375	EMC60-250-16/PE
14	300	10	60	300	318	9.0	450	EMC60-300-10/PE
15	300	16	60	300	326	13.0	450	EMC60-300-16/PE
16	350	10	60	350	370	10.0	525	EMC60-350-10/PE

Disclaimer

Whilst every care is taken to ensure that the information on this website is complete and accurate, the Rotec Composite Group BV cannot accept responsibility for any omissions or inaccuracies or for any consequences arising therefrom. By using this website, the user accepts the terms of this disclaimer.

Bögen

Bogen 60 Grad Typ PE

Resin Type: Derakane 470

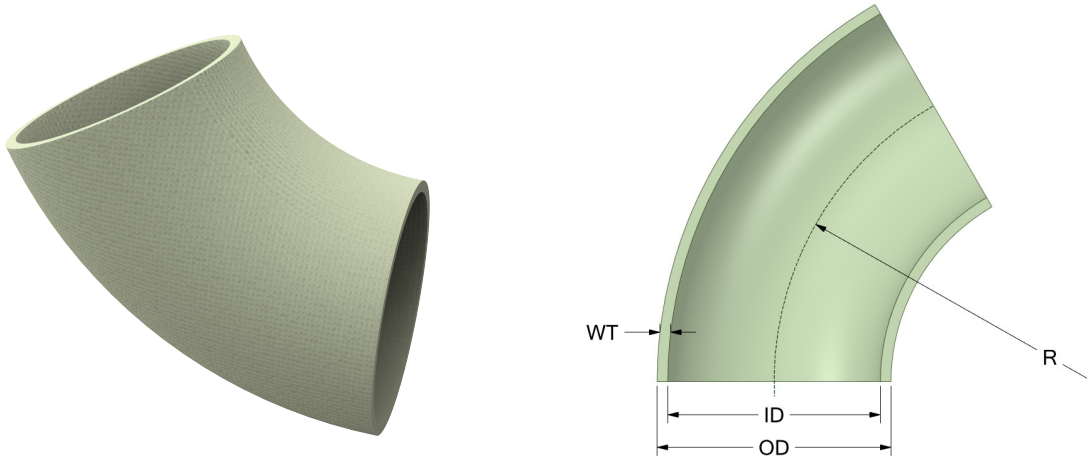

#	DN (mm)	Pmax (bar)	Bend Angle (deg)	ID (mm)	OD (mm)	WT (mm)	R (mm)	Article Number
17	350	16	60	350	365	8.5	525	EMC60-350-16/PE
18	400	10	60	394	408	7.0	600	EMC60-400-10/PE
19	400	16	60	394	412	9.0	600	EMC60-400-16/PE
20	450	10	60	434	450	8.0	675	EMC60-450-10/PE
21	450	16	60	434	455	10.5	675	EMC60-450-16/PE
22	500	10	60	482	502	10.0	750	EMC60-500-10/PE
23	500	16	60	482	508	13.0	750	EMC60-500-16/PE
24	600	10	60	579	603	12.0	900	EMC60-600-10/PE
25	600	16	60	579	609	15.0	900	EMC60-600-16/PE

Disclaimer

Whilst every care is taken to ensure that the information on this website is complete and accurate, the Rotec Composite Group BV cannot accept responsibility for any omissions or inaccuracies or for any consequences arising therefrom. By using this website, the user accepts the terms of this disclaimer.