

# Rotec Fest Flansche

## Flat Face RTM für GFK-Rohr

Drilling Standard: AWWA C207 Class B/D/E



| #  | DN<br>(mm) | Pmax<br>(bar) | D<br>(mm) | d7<br>(mm) | d9<br>(mm) | d8<br>(mm) | d5<br>(mm) | r2<br>(mm) | k<br>(mm) | Holes<br>(no.) | d2<br>(mm) | h2<br>(mm) | b2<br>(mm) | Article Number |
|----|------------|---------------|-----------|------------|------------|------------|------------|------------|-----------|----------------|------------|------------|------------|----------------|
| 1  | 150        | 10            | 285       | 167        | 171        | 178        | 186        | 6          | 241       | 8              | 22         | 70         | 23         | FF-150-10/AW5  |
| 2  | 150        | 16            | 285       | 167        | 171        | 178        | 186        | 6          | 241       | 8              | 22         | 77         | 30         | FF-150-16/AW5  |
| 3  | 200        | 10            | 350       | 221        | 225        | 230        | 240        | 6          | 298       | 8              | 22         | 81         | 26         | FF-200-10/AW5  |
| 4  | 200        | 16            | 350       | 221        | 225        | 230        | 240        | 6          | 298       | 8              | 22         | 91         | 36         | FF-200-16/AW5  |
| 5  | 250        | 10            | 410       | 273        | 277        | 288        | 294        | 6          | 362       | 12             | 25         | 89         | 29         | FF-250-10/AW5  |
| 6  | 250        | 16            | 410       | 273        | 277        | 288        | 294        | 6          | 362       | 12             | 25         | 102        | 42         | FF-250-16/AW5  |
| 7  | 300        | 10            | 490       | 326        | 330        | 338        | 354        | 9          | 432       | 12             | 25         | 97         | 32         | FF-300-10/AW5  |
| 8  | 300        | 16            | 490       | 326        | 330        | 338        | 354        | 9          | 432       | 12             | 25         | 113        | 48         | FF-300-16/AW5  |
| 9  | 350        | 10            | 540       | 378        | 382        | 390        | 402        | 8          | 476       | 12             | 28         | 105        | 35         | FF-350-10/AW5  |
| 10 | 350        | 16            | 540       | 378        | 382        | 390        | 402        | 8          | 476       | 12             | 28         | 124        | 54         | FF-350-16/AW5  |
| 11 | 400        | 10            | 600       | 429        | 433        | 441        | 455        | 8          | 540       | 16             | 28         | 113        | 38         | FF-400-10/AW5  |
| 12 | 400        | 16            | 600       | 429        | 433        | 441        | 455        | 8          | 540       | 16             | 28         | 135        | 60         | FF-400-16/AW5  |
| 13 | 450        | 10            | 644       | 480        | 484        | 495        | 506        | 8          | 578       | 16             | 32         | 121        | 41         | FF-450-10/AW5  |
| 14 | 450        | 16            | 644       | 480        | 484        | 495        | 506        | 8          | 578       | 16             | 32         | 146        | 66         | FF-450-16/AW5  |
| 15 | 500        | 3             | 720       | 532        | 536        | 547        | 560        | 8          | 635       | 20             | 32         | 116        | 31         | FF-500-03/AW5  |
| 16 | 500        | 10            | 720       | 532        | 536        | 547        | 560        | 8          | 635       | 20             | 32         | 129        | 44         | FF-500-10/AW5  |
| 17 | 500        | 16            | 720       | 532        | 536        | 547        | 560        | 8          | 635       | 20             | 32         | 157        | 72         | FF-500-16/AW5  |
| 18 | 600        | 3             | 844       | 618        | 622        | 637        | 652        | 10         | 749       | 20             | 35         | 129        | 34         | FF-600-03/AW5  |

### Disclaimer

Whilst every care is taken to ensure that the information on this website is complete and accurate, the Rotec Composite Group BV cannot accept responsibility for any omissions or inaccuracies or for any consequences arising therefrom. By using this website, the user accepts the terms of this disclaimer.

# Rotec Fest Flansche

## Flat Face RTM für GFK-Rohr

Drilling Standard: AWWA C207 Class B/D/E

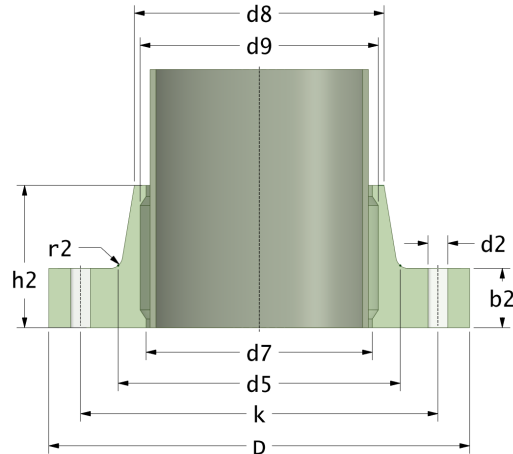

| #  | DN<br>(mm) | Pmax<br>(bar) | D<br>(mm) | d7<br>(mm) | d9<br>(mm) | d8<br>(mm) | d5<br>(mm) | r2<br>(mm) | k<br>(mm) | Holes<br>(no.) | d2<br>(mm) | h2<br>(mm) | b2<br>(mm) | Article Number |
|----|------------|---------------|-----------|------------|------------|------------|------------|------------|-----------|----------------|------------|------------|------------|----------------|
| 19 | 600        | 10            | 844       | 618        | 622        | 637        | 652        | 10         | 749       | 20             | 35         | 145        | 50         | FF-600-10/AW5  |
| 20 | 600        | 16            | 844       | 618        | 622        | 637        | 652        | 10         | 749       | 20             | 35         | 179        | 84         | FF-600-16/AW5  |
| 21 | 630        | 3             | 844       | 631        | 635        | 644        | 666        | 12         | 749       | 20             | 35         | 129        | 34         | FF-630-03/AW5  |
| 22 | 630        | 10            | 844       | 631        | 635        | 644        | 666        | 12         | 749       | 20             | 35         | 145        | 50         | FF-630-10/AW5  |
| 23 | 630        | 16            | 844       | 631        | 635        | 644        | 666        | 12         | 749       | 20             | 35         | 179        | 84         | FF-630-16/AW5  |
| 24 | 700        | 3             | 930       | 720        | 724        | 733        | 758        | 11         | 864       | 28             | 35         | 142        | 37         | FF-700-03/AW5  |
| 25 | 700        | 10            | 930       | 720        | 724        | 733        | 758        | 11         | 864       | 28             | 35         | 161        | 56         | FF-700-10/AW5  |
| 26 | 700        | 16            | 930       | 720        | 724        | 733        | 758        | 11         | 864       | 28             | 35         | 201        | 96         | FF-700-16/AW5  |
| 27 | 800        | 3             | 1085      | 822        | 826        | 835        | 858        | 18         | 978       | 28             | 41         | 155        | 40         | FF-800-03/AW5  |
| 28 | 800        | 10            | 1085      | 822        | 826        | 835        | 858        | 18         | 978       | 28             | 41         | 177        | 62         | FF-800-10/AW5  |
| 29 | 800        | 16            | 1085      | 822        | 826        | 835        | 858        | 18         | 978       | 28             | 41         | 223        | 108        | FF-800-16/AW5  |
| 30 | 900        | 3             | 1190      | 924        | 928        | 939        | 964        | 18         | 1086      | 32             | 41         | 168        | 43         | FF-900-03/AW5  |
| 31 | 900        | 6             | 1190      | 924        | 928        | 939        | 964        | 18         | 1086      | 32             | 41         | 181        | 56         | FF-900-06/AW5  |
| 32 | 900        | 10            | 1190      | 924        | 928        | 939        | 964        | 18         | 1086      | 32             | 41         | 193        | 68         | FF-900-10/AW5  |
| 33 | 900        | 16            | 1190      | 924        | 928        | 939        | 964        | 18         | 1086      | 32             | 41         | 245        | 120        | FF-900-16/AW5  |
| 34 | 1000       | 3             | 1320      | 1026       | 1030       | 1044       | 1075       | 18         | 1200      | 36             | 41         | 186        | 46         | FF-1000-03/AW5 |
| 35 | 1000       | 6             | 1320      | 1026       | 1030       | 1044       | 1075       | 18         | 1200      | 36             | 41         | 200        | 60         | FF-1000-06/AW5 |
| 36 | 1000       | 10            | 1320      | 1026       | 1030       | 1044       | 1075       | 18         | 1200      | 36             | 41         | 214        | 74         | FF-1000-10/AW5 |

### Disclaimer

Whilst every care is taken to ensure that the information on this website is complete and accurate, the Rotec Composite Group BV cannot accept responsibility for any omissions or inaccuracies or for any consequences arising therefrom. By using this website, the user accepts the terms of this disclaimer.

# Rotec Fest Flansche

## Flat Face RTM für GFK-Rohr

Drilling Standard: AWWA C207 Class B/D/E



| #  | DN<br>(mm) | Pmax<br>(bar) | D<br>(mm) | d7<br>(mm) | d9<br>(mm) | d8<br>(mm) | d5<br>(mm) | r2<br>(mm) | k<br>(mm) | Holes<br>(no.) | d2<br>(mm) | h2<br>(mm) | b2<br>(mm) | Article Number |
|----|------------|---------------|-----------|------------|------------|------------|------------|------------|-----------|----------------|------------|------------|------------|----------------|
| 37 | 1000       | 16            | 1320      | 1026       | 1030       | 1044       | 1075       | 18         | 1200      | 36             | 41         | 272        | 132        | FF-1000-16/AW5 |
| 38 | 1100       | 3             | 1430      | 1102       | 1106       | 1118       | 1140       | 25         | 1314      | 40             | 41         | 159        | 49         | FF-1101-03/AW5 |
| 39 | 1100       | 3             | 1430      | 1128       | 1132       | 1146       | 1170       | 18         | 1314      | 40             | 41         | 159        | 49         | FF-1102-03/AW5 |
| 40 | 1100       | 6             | 1430      | 1102       | 1106       | 1118       | 1140       | 25         | 1314      | 40             | 41         | 175        | 65         | FF-1101-06/AW5 |
| 41 | 1100       | 6             | 1430      | 1128       | 1132       | 1146       | 1170       | 18         | 1314      | 40             | 41         | 175        | 65         | FF-1102-06/AW5 |
| 42 | 1100       | 10            | 1430      | 1102       | 1106       | 1118       | 1140       | 25         | 1314      | 40             | 41         | 190        | 80         | FF-1101-10/AW5 |
| 43 | 1100       | 10            | 1430      | 1128       | 1132       | 1146       | 1170       | 18         | 1314      | 40             | 41         | 190        | 80         | FF-1102-10/AW5 |
| 44 | 1100       | 16            | 1430      | 1102       | 1106       | 1118       | 1160       | 25         | 1314      | 40             | 41         | 304        | 144        | FF-1101-16/AW5 |
| 45 | 1100       | 16            | 1430      | 1128       | 1132       | 1146       | 1170       | 18         | 1314      | 40             | 41         | 314        | 144        | FF-1102-16/AW5 |
| 46 | 1200       | 3             | 1520      | 1231       | 1235       | 1250       | 1280       | 14         | 1422      | 44             | 41         | 172        | 52         | FF-1200-03/AW5 |
| 47 | 1200       | 6             | 1520      | 1231       | 1235       | 1250       | 1280       | 14         | 1422      | 44             | 41         | 189        | 69         | FF-1200-06/AW5 |
| 48 | 1200       | 10            | 1520      | 1231       | 1235       | 1250       | 1280       | 14         | 1422      | 44             | 41         | 206        | 86         | FF-1200-10/AW5 |
| 49 | 1200       | 16            | 1520      | 1231       | 1235       | 1250       | 1280       | 14         | 1422      | 44             | 41         | 331        | 156        | FF-1200-16/AW5 |
| 50 | 1350       | 3             | 1695      | 1384       | 1388       | 1402       | 1440       | 18         | 1594      | 44             | 47         | 257        | 57         | FF-1350-03/AW5 |
| 51 | 1350       | 6             | 1695      | 1384       | 1388       | 1402       | 1440       | 18         | 1594      | 44             | 47         | 276        | 76         | FF-1350-06/AW5 |
| 52 | 1350       | 10            | 1695      | 1384       | 1388       | 1402       | 1440       | 18         | 1594      | 44             | 47         | 295        | 95         | FF-1350-10/AW5 |
| 53 | 1350       | 16            | 1695      | 1384       | 1388       | 1402       | 1440       | 18         | 1594      | 44             | 47         | 374        | 174        | FF-1350-16/AW5 |
| 54 | 1500       | 3             | 1870      | 1537       | 1541       | 1558       | 1590       | 25         | 1759      | 52             | 47         | 221        | 61         | FF-1500-03/AW5 |

### Disclaimer

Whilst every care is taken to ensure that the information on this website is complete and accurate, the Rotec Composite Group BV cannot accept responsibility for any omissions or inaccuracies or for any consequences arising therefrom. By using this website, the user accepts the terms of this disclaimer.

# Rotec Fest Flansche

## Flat Face RTM für GFK-Rohr

Drilling Standard: AWWA C207 Class B/D/E

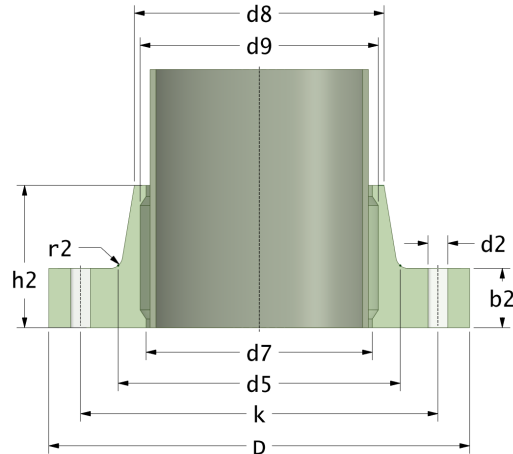

| #  | DN<br>(mm) | Pmax<br>(bar) | D<br>(mm) | d7<br>(mm) | d9<br>(mm) | d8<br>(mm) | d5<br>(mm) | r2<br>(mm) | k<br>(mm) | Holes<br>(no.) | d2<br>(mm) | h2<br>(mm) | b2<br>(mm) | Article Number |
|----|------------|---------------|-----------|------------|------------|------------|------------|------------|-----------|----------------|------------|------------|------------|----------------|
| 55 | 1500       | 6             | 1870      | 1537       | 1541       | 1558       | 1590       | 25         | 1759      | 52             | 47         | 243        | 83         | FF-1500-06/AW5 |
| 56 | 1500       | 10            | 1870      | 1537       | 1541       | 1558       | 1590       | 25         | 1759      | 52             | 47         | 264        | 104        | FF-1500-10/AW5 |
| 57 | 1500       | 16            | 1870      | 1537       | 1541       | 1558       | 1590       | 25         | 1759      | 52             | 47         | 412        | 192        | FF-1500-16/AW5 |
| 58 | 1800       | 3             | 2210      | 1844       | 1848       | 1866       | 1900       | 25         | 2096      | 60             | 47         | 260        | 70         | FF-1800-03/AW5 |
| 59 | 1800       | 6             | 2210      | 1844       | 1848       | 1866       | 1900       | 25         | 2096      | 60             | 47         | 286        | 96         | FF-1800-06/AW5 |
| 60 | 1800       | 10            | 2210      | 1844       | 1848       | 1866       | 1900       | 25         | 2096      | 60             | 47         | 312        | 122        | FF-1800-10/AW5 |
| 61 | 1800       | 16            | 2210      | 1844       | 1848       | 1866       | 1900       | 18         | 2096      | 60             | 47         | 498        | 228        | FF-1800-16/AW5 |
| 62 | 2100       | 3             | 2560      | 2150       | 2154       | 2172       | 2210       | 25         | 2426      | 64             | 54         | 299        | 79         | FF-2100-03/AW5 |
| 63 | 2100       | 6             | 2560      | 2150       | 2154       | 2172       | 2210       | 25         | 2426      | 64             | 54         | 330        | 110        | FF-2100-06/AW5 |
| 64 | 2100       | 10            | 2560      | 2150       | 2154       | 2172       | 2210       | 25         | 2426      | 64             | 54         | 360        | 140        | FF-2100-10/AW5 |
| 65 | 2400       | 3             | 2900      | 2458       | 2462       | 2480       | 2530       | 25         | 2756      | 68             | 62         | 338        | 88         | FF-2400-03/AW5 |
| 66 | 2400       | 6             | 2900      | 2458       | 2462       | 2480       | 2530       | 25         | 2756      | 68             | 62         | 373        | 123        | FF-2400-06/AW5 |
| 67 | 2400       | 10            | 2900      | 2458       | 2462       | 2480       | 2530       | 25         | 2756      | 68             | 62         | 408        | 158        | FF-2400-10/AW5 |

### Disclaimer

Whilst every care is taken to ensure that the information on this website is complete and accurate, the Rotec Composite Group BV cannot accept responsibility for any omissions or inaccuracies or for any consequences arising therefrom. By using this website, the user accepts the terms of this disclaimer.

17-11-2022